

You can find the detailed operating instructions on the internet at <http://www.ptcarphone.eu/user-manual>

COMMUNICATION AT ITS BEST

COMMUNICATION AT ITS BEST

COMMUNICATION AT ITS BEST

## Safety Instructions

### Emergency Calls

Like every other mobile telephone, this device functions with radio signals, mobile radio and landline networks and with user-programmed functions. The establishing of a connection can therefore not be guaranteed in all situations. For this reason, you should not rely entirely upon the device in cases of vitally important communication (e.g. medical emergencies).

Remember that you can only make and receive calls with the device when it is switched on and in a service area with sufficient signal strength. Under certain circumstances, emergency calls cannot be made in all mobile radio networks; it is also possible that they cannot be made if certain network services and/or telephone functions are active.

### Traffic Safety

While driving only use the hands-free function of the device. The handset must only be used for calls when the vehicle is stationary. Always fasten the handset in its holder; do not place the handset on the seat or a place from which it can come free in a collision or a sudden braking manoeuvre. The hands-free arrangement is only active if the handset is in its rest.

### Operating Environment

Observe legal regulations and local restrictions when using the device. Switch the device off with the on/off key everywhere where this is requested by corresponding warning signs or where dangers could arise, e.g. close to fuel and/or flammable chemicals.

### Health

The functioning of medical devices such as hearing aids and heart pacemakers can be disrupted. Keep a minimum distance of at least 20cm between the telephone and pacemakers. During a conversation hold the telephone to the ear furthest away from the pacemaker. For further information consult your doctor.

### Electronic Devices

Under certain circumstances high frequency signals can impair the function of incorrectly installed or insufficiently shielded electronic systems in the vehicle.

### Accessories

Only use accessories that are approved for use with this device. The use of non-approved accessories leads to loss of the warranty and can result in the user being criminally prosecuted. Ask your dealer or the manufacturer about approved accessories.

### Maintenance, Installation and Repairs

Only qualified specialist personnel can maintain, install and/or use this device. The device must not be opened. Any change to the device is not permitted and leads to the loss of the warranty.

### Network Services

The telephone described in these operating instructions is for use in GSM 850-/900- and GSM 1800-/1900-mobile radio networks.

Some functions described in the operating instructions are called network services. Network services are special services that are made available at the request of the user by his provider. Before the user can make use of them, he must have acquired the authorisation to use these services from his provider.

It is possible that some networks do not support all services.

## Character Maps

Repeated pressing of an input key in the letter mode switches between the different available characters of this input key.

### Large Font Mode

Key	1x	2x	3x	4x	5x	6x	7x	8x	9x	10x	11x	12x	13x	14x
1	.	,	'	?	!	"	1	-	(	)	/	:	-	
2	A	B	C	2	Ä	Å	Æ	Ç						
3	D	E	F	3	È									
4	G	H	I	4	Ï									
5	J	K	L	5	\$									
6	M	N	O	6	Ö	Ñ	Ø							
7	P	Q	R	7	ß	¥								
8	T	U	V	8	Ü	Û								
9	W	X	Y	9										
0	_	+	=	0	Δ	Φ	Γ	Λ	Ω	Π	Ψ	Σ	Θ	≡
*	*	#	;	<	>	&	Ï	@	£	¿				

### Small Font Mode

Key	1x	2x	3x	4x	5x	6x	7x	8x	9x	10x	11x	12x	13x	14x
1	.	,	'	?	!	"	1	-	(	)	/	:	-	
2	a	b	c	2	ä	å	æ	ç						
3	d	e	f	3	è	é								
4	g	h	i	4	ï									
5	j	k	l	5	\$									
6	m	n	o	6	ö	ñ	ø							
7	p	q	r	7	ß									
8	t	u	v	8	ü	û								
9	w	x	y	9										
0	_	+	=	0	Δ	Φ	Γ	Λ	Ω	Π	Ψ	Σ	Θ	≡
*	*	#	;	<	>	&	Ï	@	£	¿				

You can find further information in the detailed operating instructions and on the website [www.ptcarphone.eu](http://www.ptcarphone.eu).

PEI TEL Communications GmbH  
Potsdamer Str. 12 b, 14513 Teltow, Tel: +49 (0) 3328 - 3516 0, Fax: +49 (0) 3328 - 3516 16

1053-085-001-100 Rev.: 1.1

# PTCarPhone 3 Brief Instructions



PEI TEL  
Communications  
A member of PEIKER group

## Overview

### Display Keys

The current functions of the left and right display keys are displayed in the lowest display line as text symbols

### End Key

- End of conversation or abort/block
- Return to the main view of the display

### Connection key

Call processing or accept call

### Control Key

For flicking up and down in lists and menus

### Input Keys

Input of numerals and letters

### On/Off Key

Keep pressed to switch device on or off

### Mute Key

For muting of the active microphone (the muting is automatically lifted at the end of every conversation)



### Text Symbols Display Keys 1

Text symbols for the current functions of the left and right display key

### Control Symbols 2

Show whether upward/downward scrolling is possible

### Main Window 3

Display of information on the present function; time or current provider in the main view of the display

### Symbol Bar 4

Shows display symbols as described in the following:

- Strength of the reception signal
- Volume in private mode
- Volume in hands-free mode
- The active microphone is muted
- Switched on: unread SMS in in-box  
Flashing: storage left for only one more SMS
- Roaming/Foreign Service Provider; the current service provider is displayed, and below this the home service provider

### Activated GPS:

- 1 No valid position
- 2 Two-dimensional position
- 3 Three-dimensional position

## Scope of Supply

- 1 Handset
- 2 Loudspeaker
- 3 Electronics Box
- 4 Hands-Free Microphone
- 5 Extension Cable for Handset
- 6 Cable set with second interface (not shown)
- 7 Brief Instructions (not shown)



## Making Calls

### Emergency Call (Network Service)

The call number 112 is released as an emergency call number, which can be dialled even without a PIN number. To do this, enter the emergency call number and start the dialling process by pressing the connection key.

**Note:** In order to be able to make an emergency call, a SIM card activated by the provider must be in the device.

### Dialling with Number Keys

Enter the call number using the input keys and start the connection process with DIAL or the connection key.

### Redialling

Press the connection key in the main view of the display and choose the desired participant by using the control key. The dialling process is initiated by pressing repeatedly on the connection key.

### Quick Dialling

A long press on one of the input keys (1-9) causes the saved telephone book entry to be displayed, if one exists. The selected participant is dialled with DIAL or the connection key.

### Dialling from the Telephone Book

Select the desired participant and start the connection process with the connection key.

### Dialling from the Call List

Select the desired participants from one of the existing call lists and start the connection process with the connection key.

### Accepting/Rejecting a Call

An incoming call can be accepted with the ACCEPT/connection key or rejected with the ABORT/end key.

### Ending a Conversation

A conversation can only be ended with ABORT or the end key.

### Setting Volume

The volume can only be adjusted during a conversation by using the control key. The volume settings for hands-free and private mode are adjusted separately and can only be adjusted in the respective mode. The currently set volume is shown in the display of the symbol bar.

### Muting

The active microphone can be muted during a conversation with the muting key. When the microphone is muted, the mute symbol appears instead of the volume symbol. The muting of the microphone is cancelled at the end of every conversation.

### Brokering/Call Waiting (Network Service)

If you receive a call while you are in an active conversation, you can answer this call by pressing on CHANGE. After you have pressed CHANGE, the device takes the call and puts the active conversation on "hold". By pressing on CHANGE again, the conversation currently on hold becomes the active one and the currently active conversation becomes the one on hold. On the display, the participant on hold is identified by (h) and the active one by (a).

You can only ever communicate with the active participant. The participant on hold is placed in a waiting loop and cannot listen to the active conversation.

## Setting Up

### Insert SIM-Card

A valid SIM card is necessary to operate the device. You will receive this from your provider. It stores all important data relating to your connection. If the SIM card has been supplied in cheque card format, separate the smaller section and remove any projecting waste pieces of plastic.

### Enter PIN

If it is necessary to enter a PIN, then you will be asked to do this by a corresponding message. Enter the PIN with the input keys and confirm them with NEXT. You can carry out a correction using DELETE. So that your PIN cannot be seen, input characters are shown with an asterisk. The following registration in the network can take a few seconds.

After entry of the PIN the main view of the display is shown.

**Note:** After three incorrect attempts to enter the PIN the SIM card is frozen. To unfreeze the PIN, you will be asked to enter the PUK (MASTER-PIN).

### Switching the Device On/Off

The telephone always switches on with the ignition signal of the vehicle. It is switched off by switching off the ignition, delayed by an adjustable run-down time.

The telephone can also be switched on or off at any time independent of the ignition signal by a long press on the on/off key.

### Private- and Hands-free Mode



Main view of the display in private mode

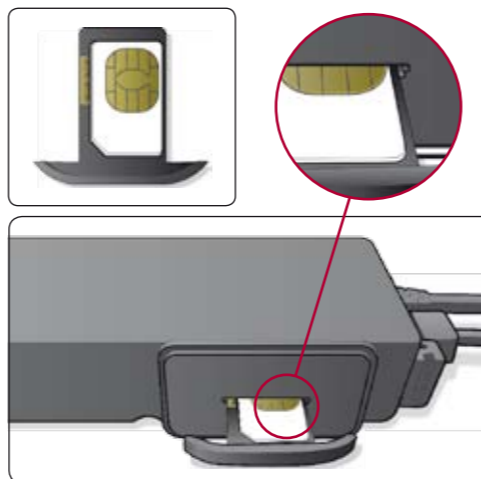

Make sure that the SIM card slides in in the right position. No great physical force is necessary!

**Note:** Only insert the SIM card into a switched-off device, i.e. with the ignition switched off and elapsed run-down time!

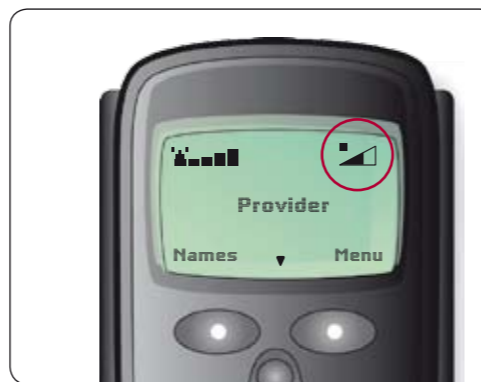

Main view of the display in the hands-free mode

## Installation

### Precautionary Measures

- The device must only be installed in the vehicle and serviced by qualified skilled personnel. Incorrect installation can cause electronic vehicle systems to malfunction. Incorrect installation or servicing can have dangerous results and lead to the voiding of the warranty and possibly of the operating licence of your vehicle.
- In vehicles that are equipped with an airbag, please be aware that the airbag is inflated with great force. Do not place any rigidly installed or movable equipment in the area that would be occupied by the inflated airbag.
- Before the device is used for the first time, the GSM and, in the case of a TPU with integrated GPS module, the GPS antenna must be connected. The device must not be operated without antenna/e because this can lead to destruction.
- In modern vehicles, under certain circumstances, adjustments may have to be carried out after clipping onto the vehicle battery. For this, be sure to consult the operating manual of your vehicle for assistance.

In the event that these instructions are not adhered to, legal measures may be initiated against the offender.

### Sequence of Installation/Starting-Up

- Unclip negative pole of the vehicle battery. Here note the safety instructions of the vehicle manufacturer.
- Familiarise yourself with the wiring diagram (picture Connection diagram).

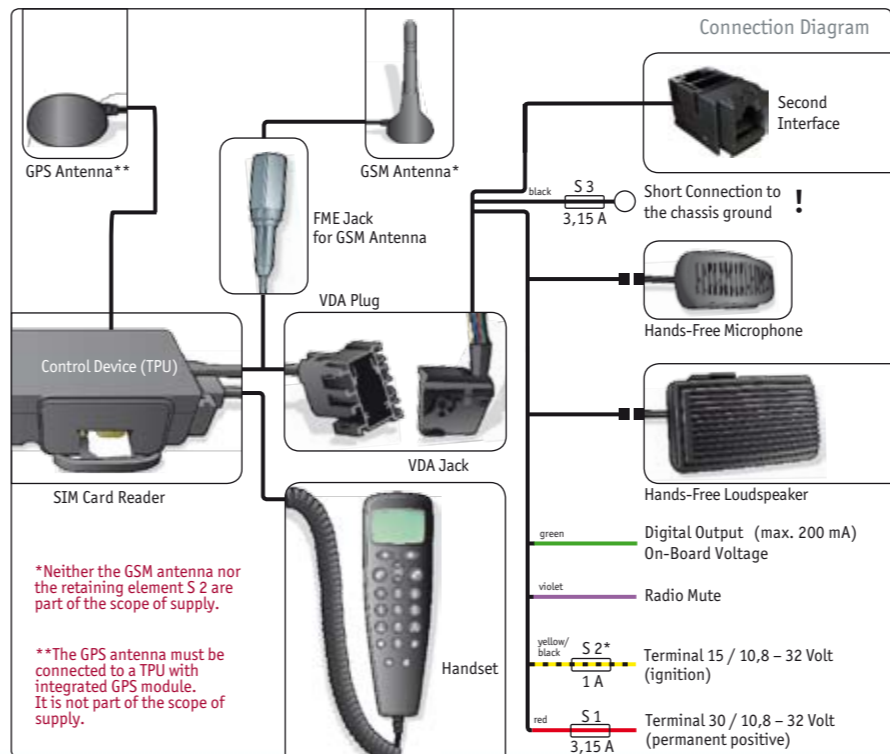

- Select places for installation and install the control device (TPU), handset, loudspeakers, microphone and antenna taking into account the cable lengths and installation instructions. When drilling holes make sure that no vehicle parts become damaged. Use cable bushings where holes have sharp edges.
- Install the microphone ME15, supplied for the hands-free kit, in accordance with the installation sketch (Picture Installation of Microphone); the best distance from the mouth is approx. 30 cm; airflows from the ventilation should not go towards the microphone (see also Picture Places to Install Microphone). The loudspeaker is then installed (the best position is in the lower front passenger footwell). When installing the microphone and loudspeaker, make sure that they are sufficiently far apart to prevent an acoustic short-circuit. In an especially loud environment the directional gooseneck microphone ME251 (accessories) can also be used.



Places to Install Microphone

- A = optimal position
- B = suitable alternative
- C = suitable to a limited extent

Installation of Microphone

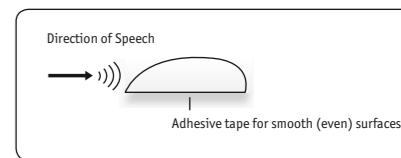

- Connect the electrical supply cable (red cable) to terminal 30 (permanent positive). It is absolutely necessary for the ignition input (yellow/black cable) to be connected to the ignition (KL15) in order for the device to be switched on automatically with the ignition. It is advised that you do not place the ignition input of the device on permanent positive, because that restricts the device's functional range. After the ignition has been switched off, the device continues to run for the programmed time and then switches itself off. The earth cable is connected directly to the vehicle battery via a 3.15 A fuse, the central earth point or a part of the vehicle body that ensures a safe earth connection.
- If required connect the violet cable to the mute output of your car radio.
- Insulate unused cables so that no short circuits can occur.
- Connect handset/s, loudspeaker, microphone and antenna/e firmly to the control device using the plug-in and/or screw joints.
- Checking of the overall installation.
- Insert valid SIM card.
- Connect vehicle battery and switch on ignition.
- Device switches itself on and requests a PIN, if this preset response has not already been switched off on the SIM card.
- Enter PIN - telephone registers itself in the network.
- Set up voice calls and test the hands-free kit.
- Carry out other activities and/or personal settings as necessary.